

Alan B. Miller Hall Directory

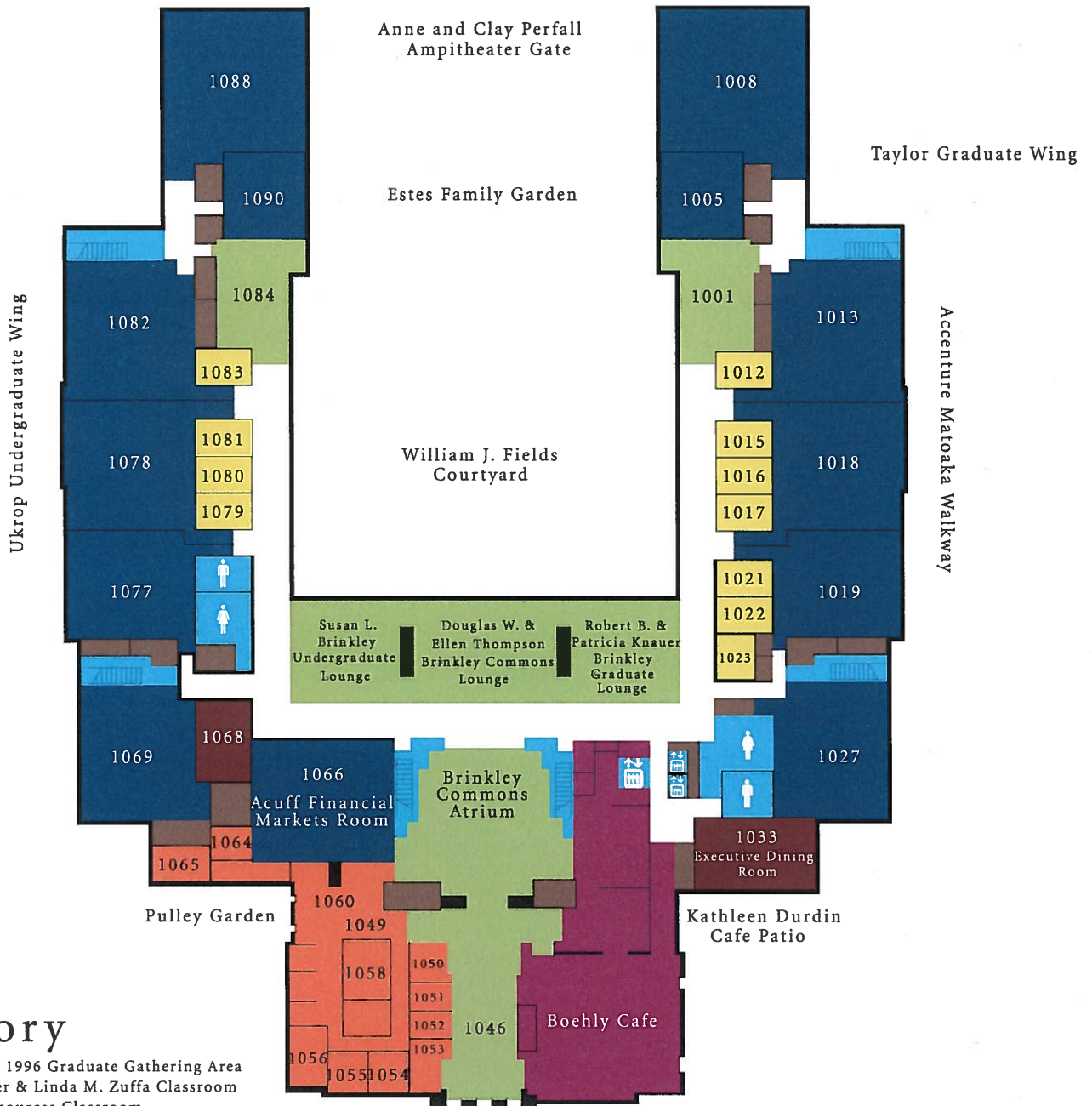

Raymond A. Mason
School of Business
WILLIAM & MARY



Directory

- 1001 - MBA Class of 1996 Graduate Gathering Area
- 1005 - Mark A. Miller & Linda M. Zuffa Classroom
- 1008 - Dominion Resources Classroom
- 1012 - MBA Class of 1980 Team Meeting Room
- 1013 - Edward T. Tokar Family Classroom
- 1015 - MBA Class of 1997 Team Meetin Room
- 1016 - MBA Class of 1998 Team Meeting Room
- 1017 - Jeff & Lucia Nicola Team Meeting Room
- 1019 - John C. Jamison Classroom
- 1021 - COL (Ret) Paul B. & Jenny Lynn Gale Team Meeting Room
- 1022 - MBA Class of 1983 Team Meeting Room
- 1023 - John & Merrl Hyman Team Meeting Room
- 1027 - Mason School of Business Faculty & Staff Classroom
- 1033 - Executive Dining Room
- 1046 - Charles A. Banks Entranceway
- 1049-1058 - Alexander & Janet Dean and Rebecca Dean Mason Career Services Suite
- 1060-1065 - Thad & Totty Shelly MBA Admissions Suite
- 1069 - Mark R. & Rosalind E. Shenkman & Gregory Shenkman Classroom

- 1077 - Mason School of Business Faculty & Staff Classroom
- 1078 - John P. Rathbone & Elizabeth S. Rathbone Classroom
- 1079 - Mark V. Lanier Family Team Meeting Room
- 1080 - Stuart L. Williams & Tuckley & Stuart Williams Jr. Team Meeting Room
- 1081 - Class of 1979, Accounting Majors Team Meeting Room
- 1082 - SunTrust Foundation Classroom
- 1083 - Rob & Patty Coble Team Meeting Room
- 1084 - Fred H. Henritze Gathering Area
- 1088 - Finance Academy Classroom
- 1090 - Deloitte Classroom

Legend

	Classrooms
	Lounges/Common Areas
	Team Meeting Rooms
	Offices
	Conference Rooms
	Maintenance Areas
	Kitchen/Cafe Areas
	Business Library
	Restrooms
	Elevators

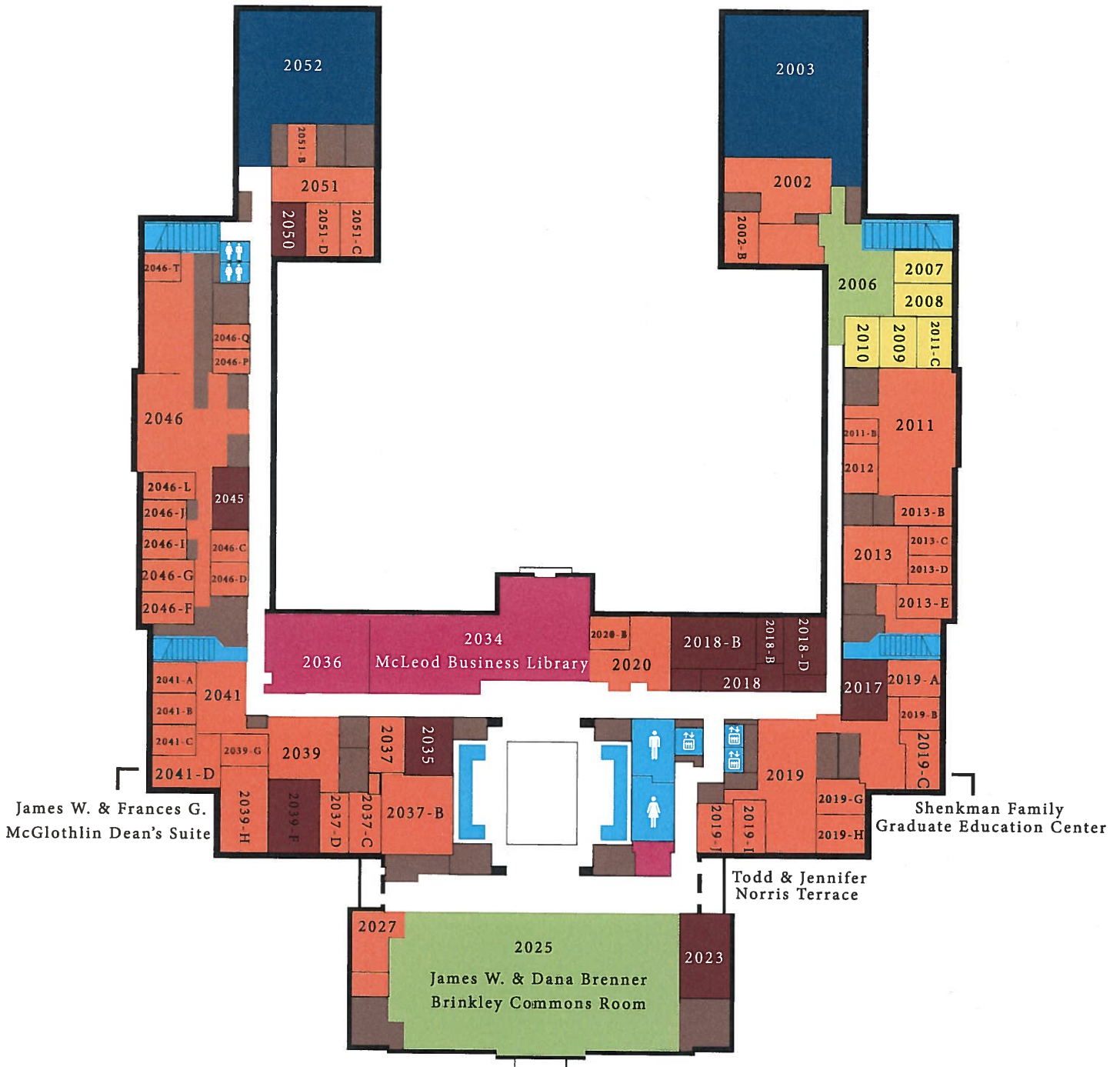

Directory

2002 - Bruce Boehm Center for Corporate Education
 2013 - Nicholas J. St. George Executive Partners Suite
 2017 - MBA Class of 1995 Conference Center
 2018 - Plumeri Communication Center
 2019-I & J - Frank J. Wood Master of Accounting Program Suite
 2023 - Conference Room
 2027 - Mason School Faculty & Staff Lounge Center
 2037 - Batten Executive Center
 2039 - Eric G. Friberg Memorial Reception Area

2039-D - MBA Class of 1967 Office
 2039-F - George Cyprian Pierides Conference Room
 2039-G - Executive Assistant to the Dean's Office
 2039-H - Dean's Office
 2041-D - Eric G. & Susan T. Fridberg Associate Dean's Office
 2045 - Richard J. Hill Conference Room
 2046-F - Cynthia L. Gelheard Office
 2050 - Cynthia & David Satterwhite Conference Room
 2051-D - Randall & Shelby Smith Hawthorne Assitant Dean's Office
 2052 - Jim & Bobbie Ukrop Innovation & Design Studio

Legend

	Classrooms		Restrooms
	Lounges/Common Areas		Elevators
	Team Meeting Rooms		
	Offices		
	Conference Rooms		
	Maintenance Areas		
	Kitchen/Cafe Areas		
	Business Library		

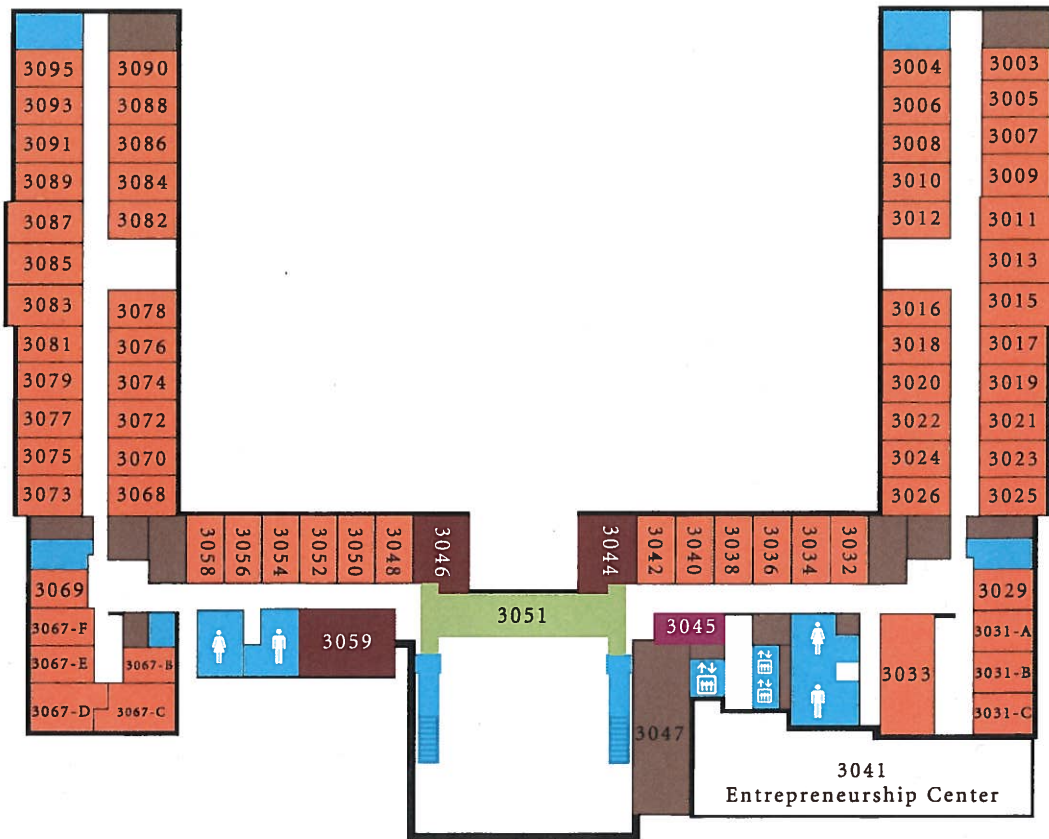

Lower Level



Lash Family Team Meeting Room MBA Class of 1985 Team Meeting Room

Directory

- 3003 - John, Stephanie, & Christine Strong Faculty Office
- 3007 - Steven Papamarcos Faculty Center
- 3019 - Lawrence J. & Kathleen M. Ring Faculty Office
- 3029 - Richard J. & Rosalie Ash Faculty Office
- 3031-C - Christopher & Wendy Hambleton Faculty Office
- 3032 - John J. "Jack" Dittrick Jr. Faculty Office
- 3033 - Mailroom
- 3036 - Brad & Louise Pulley Faculty Office
- 3041 - Alan B. Miller Entrepreneurship Center
- 3044 - Josephine V. & Jared S. Shawyer Faculty Meeting Room
- 3046 - Boehly Center for Excellence in Finance

- 3051 - Charles A. & Mari Ann Banks Faculty Lounge
- 3059 - Charles A. & Mari Ann Banks Conference Room
- 3067-C - MBA Class of 1991 Faculty Office
- 3073 - Professor Karen Locke Faculty Office
- 3077 - William T. & Susan S. Geary Faculty Office
- 3079 - Robert Edward Rahtz Faculty Office
- 3082 - Tracy Leinbach Faculty Office
- 3083 - Franklin & Adele Robeson Faculty Office
- 3084 - Austin '04 & Erin '03 Camporin Faculty Office
- 3089 - Mary Merrick & John Merrick Sr. Faculty Office

Legend

	Classrooms
	Lounges/Common Areas
	Team Meeting Rooms
	Offices
	Conference Rooms
	Maintenance Areas
	Kitchen/Cafe Areas
	Business Library
	Restrooms
	Elevators